



For future generations



Resilient Supply Chains

Sustainable Warehousing Solutions

10 June 2021

Contents

1. Sustainability Statement
2. Strategies for New Projects
3. Strategies for Existing Projects

Sustainability Statement

Design & build
carbon-negative
warehouses!



Strategies for New Projects

Energy Efficiency

Advanced Materials

Energy Generation

Software Support

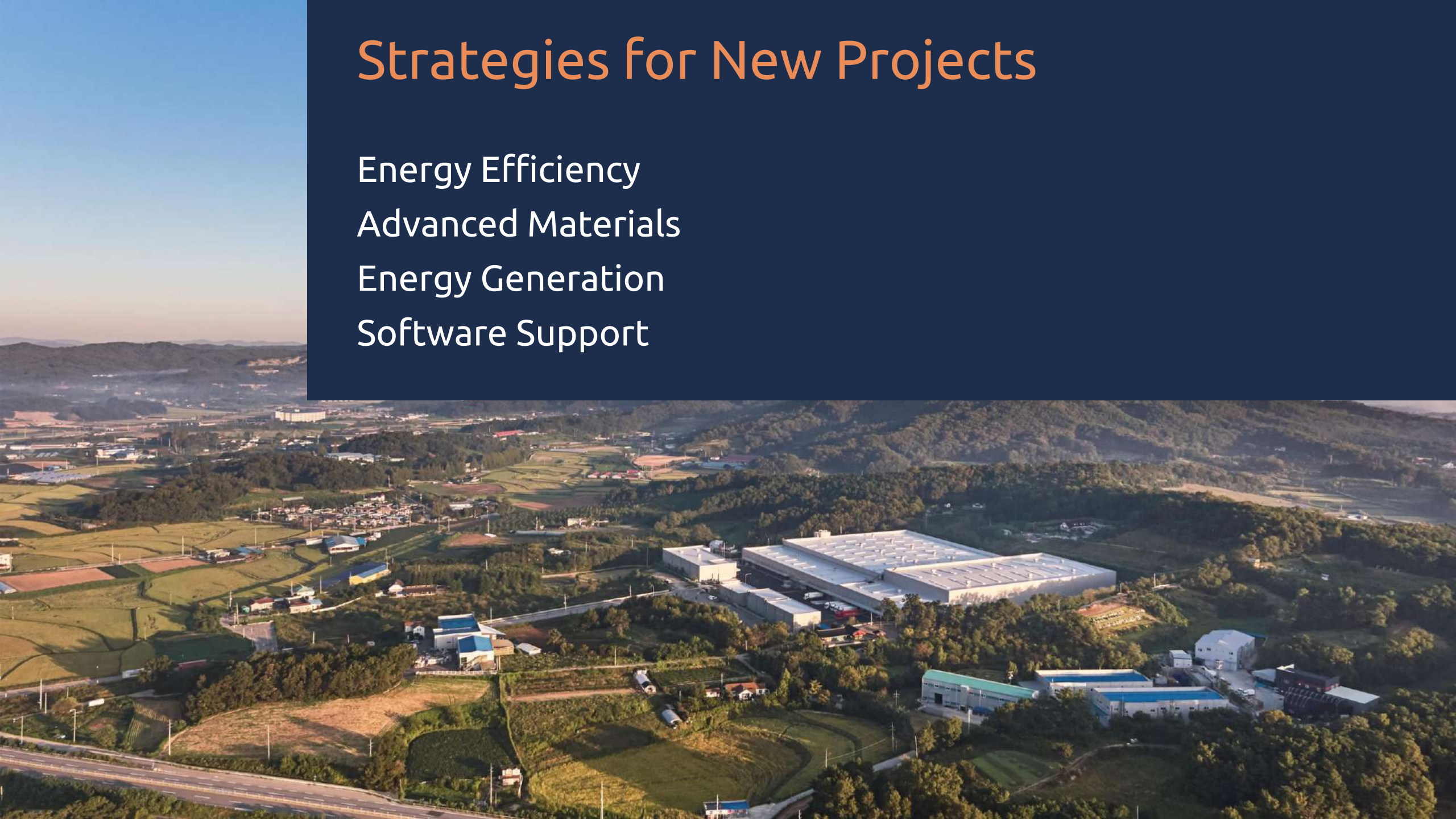

Energy Efficiency

- Passive Solutions
 - Daylighting
 - Advanced insulation for walls and roof
 - Insulated docks for temperature-controlled warehouses
 - Sun shading for offices
- Holistic View on Building Services
 - HVAC
 - Lighting
 - IT systems
 - Controls
 - Measurement



Advanced Materials

- Concrete Carbon Curing
- Carbon Reinforced Concrete
- Sensor-controlled systems for lighting
 - saves up to 80% of energy used for lighting
- Sensor-controlled HVAC system
- High-performing equipment
- Central control and monitoring of all systems

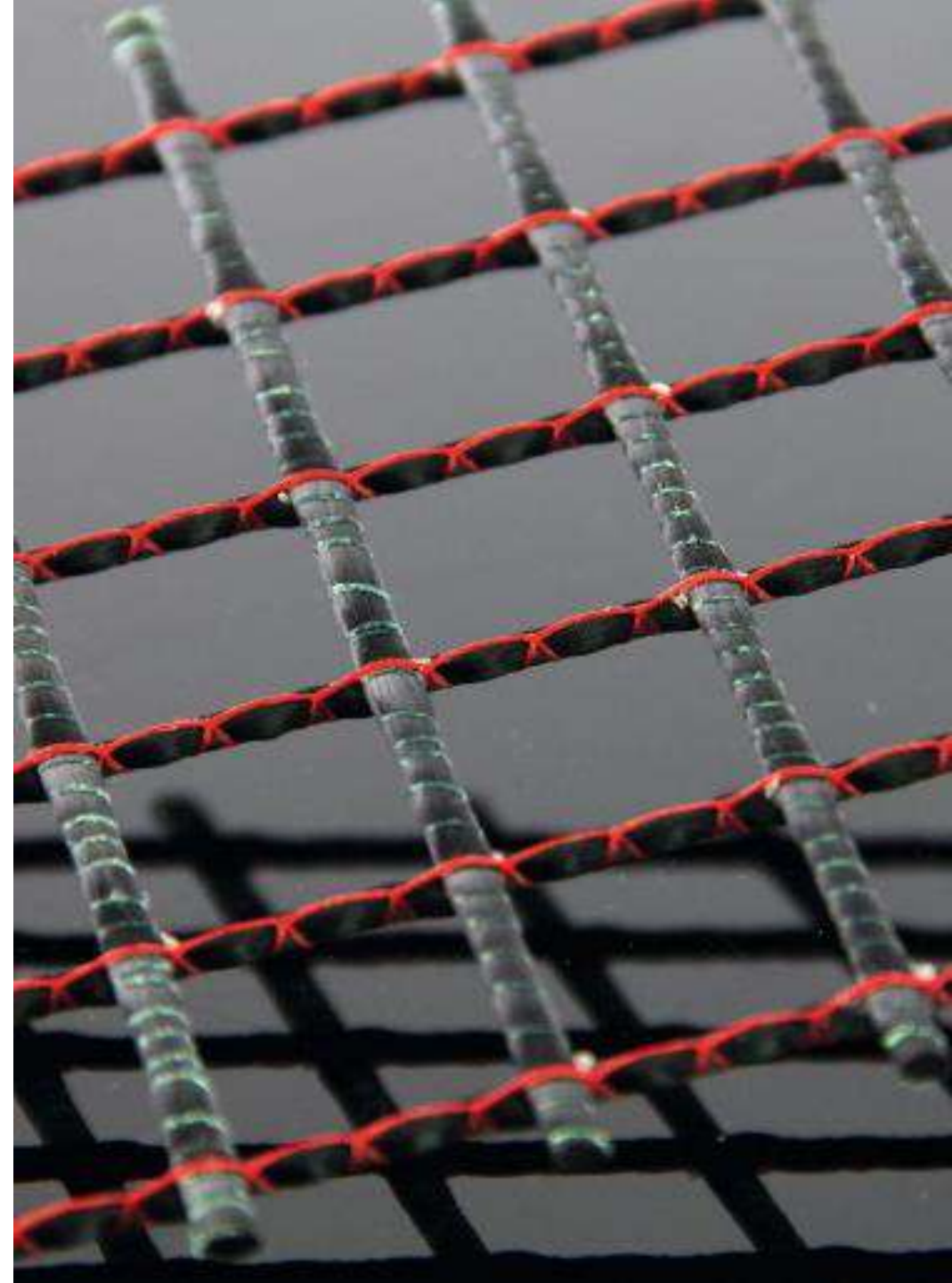

Energy Generation

- Roof Solar Panels
- About 1 MWp per 7,000 sqm of warehouse roof
 - Sufficient energy to power about 200 households, or
 - About 1,000 electric cars
- Geothermal heat pump used for heating & cooling of offices
- Geothermal heat pump used for heating of warehouse spaces





```
Highlighted Property
Name : End Mz
491 difference(s) in total
only assigned to 0 object(s) in
only assigned to 491 object(s) in
0 other modification(s)
```

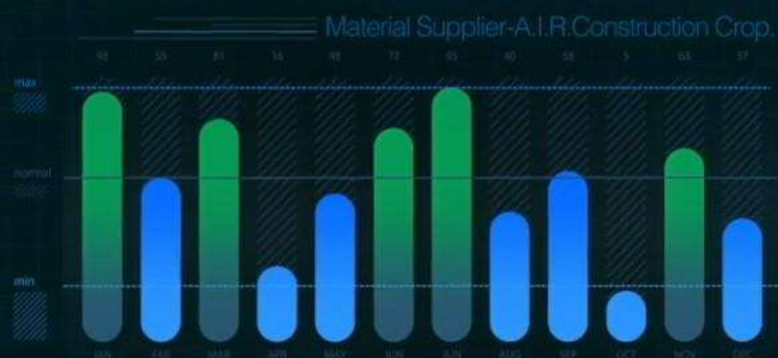
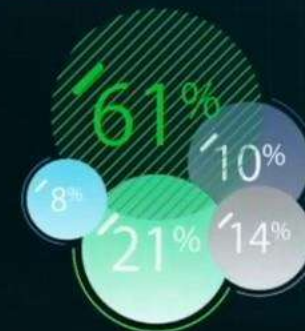

A horizontal bar chart comparing 'EMISSION LEVELS' (blue bars) and 'CARON NEGATIVE' (green bars) across five categories. The categories are represented by five rows. The blue bars are consistently longer than the green bars, indicating higher emission levels compared to the Caron Negative baseline. The green bars end with a diagonal hatching pattern.

Category	Emission Levels (Blue)	Caron Negative (Green)
1	High	Medium-High
2	High	Medium-High
3	High	Medium-High
4	High	Medium-High
5	High	Medium-High

/// EMISSION LEVELS /// CARON NEGATIVE

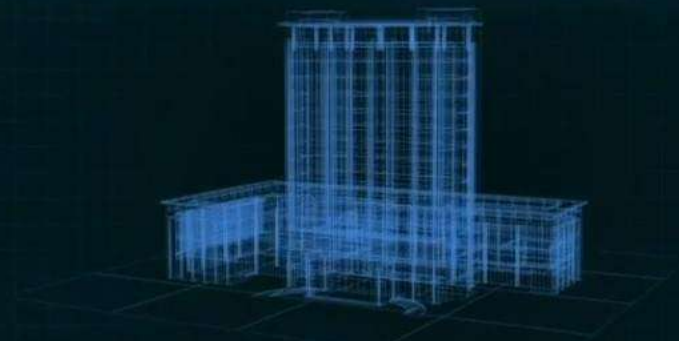
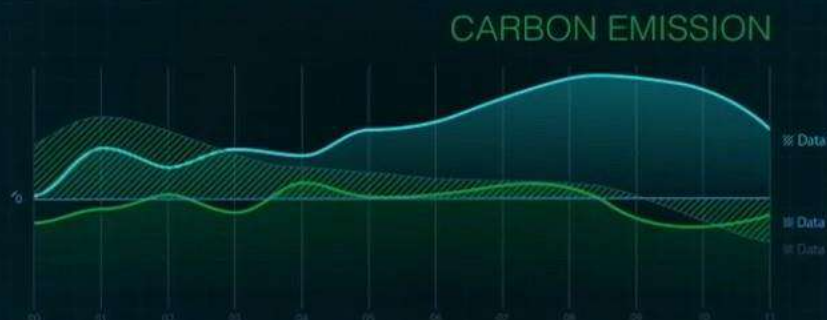

Software Support

What is Coming Next?

- Planned to install solar roofs on new building of >200,000 sqm roof spaces with >30 MWp (2022-23)
- Wood construction
- Power storage solutions
- Triple Zero
 - Energy
 - Water
 - Waste

Carbon emission information

Highlighted Property
Name : End Mz
491 difference(s) in total
only assigned to 0 object(s) in
only assigned to 491 object(s) in
0 other modification(s)

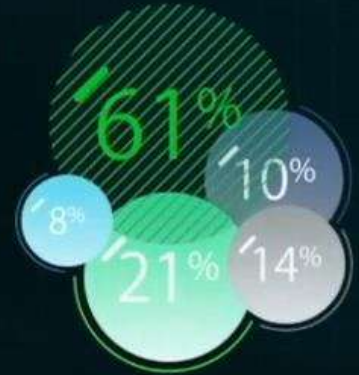

CARBON EMISSION



/// EMISSION LEVELS /// CARON NEGATIVE

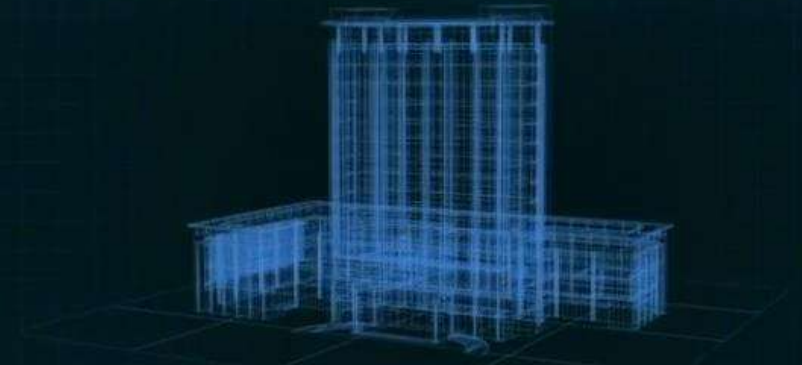

Strategies for Existing Properties

Retrofit and Expansion
Solar Roofs



Retrofit & Expansion

- Replaced Diesel by LPG as fuel for warehouse heating
- Used underfloor heating system in warehouse extension
- Used geothermal heat pump used for heating & cooling of offices



Solar Panel Retrofit

- Kicked off retrofitting of about 140,000 sqm of warehouse roof
- Planned to installing about 20 MWp, sufficient to supply about 4,000 households or 20,000 electric cars with power
- Will turn all Equalbase warehouses into Plus Energy facilities



Our Mission

Providing world-class commercial and industrial real estate solutions through building sustainable innovation



Contact

Paul Lee

Executive Director

T +65 6671 0781 | **M** +65 9459 4607

lee.paul@panalogs.com

Equalbase Development Pte Ltd

Level 4 | 21 Changi North Way

Singapore 498774

www.equalbase.com





For future generations

Inspiring
Power 
Revolution.

啟動電力革命

Asia Hydrogen Energy Fuel of Future

2021/06/10

Becky Shih

Senior Project Manager

ASIA HYDROGEN ENERGY CORP.
Product Planning Div.



CONTENT

01

Company Introduction

02

Power Generation Solutions

03

Mobile Application Solutions

01

PART ONE

Company Introduction



Company Profile

Inspiring
Power 
Revolution.

“More Eco-friendly & Higher Efficient
Energy Systems to Transform Power
Generation, Transport, and Energy Use”

Company Name	ASIA HYDROGEN ENERGY Corp. (AHE)
Business	Distributed Energy System
Location	Hsinchu Science Park, Taiwan

How to Build Next Generation Power Plant?

- + Electricity Shortage → Safe & Eco-friendly Electricity Generation
- + More Power plants → Land use、Water supply、Pollution Control、Waste Management
- + Minimize & Optimize → High Efficiency、Load Flexibility
- + Traditional Generators → Noise、Emission、Maintenance Cycle

Past : Centralized Power Plant



Future : Distributed Power Stations



Decentralized Power System in the Future: Clean, Efficient, Diverse

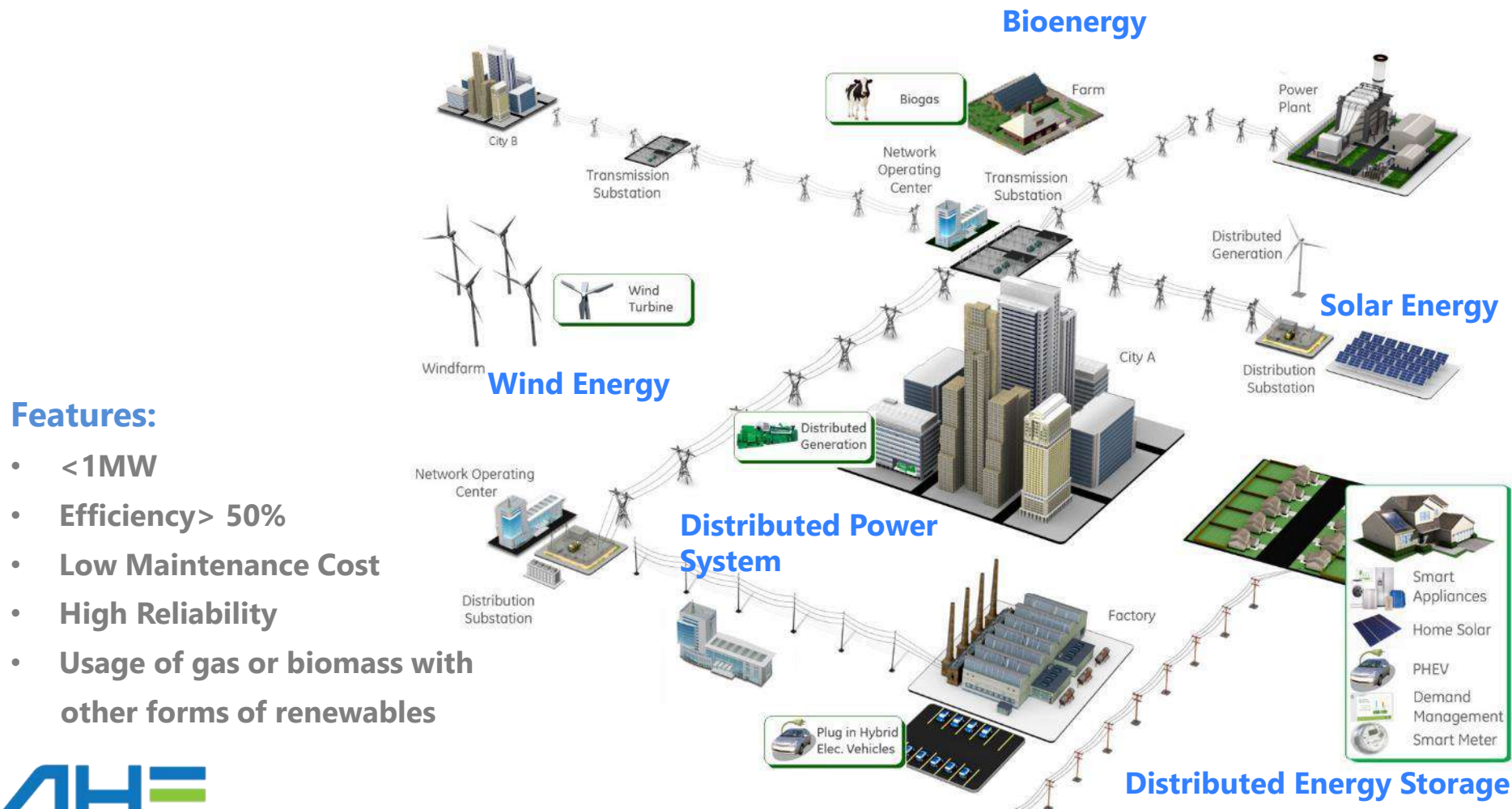

Features:

- <1MW
- Efficiency > 50%
- Low Maintenance Cost
- High Reliability
- Usage of gas or biomass with other forms of renewables

02

PART TWO

● Power Generation Solutions ●



FC System Solutions Outline

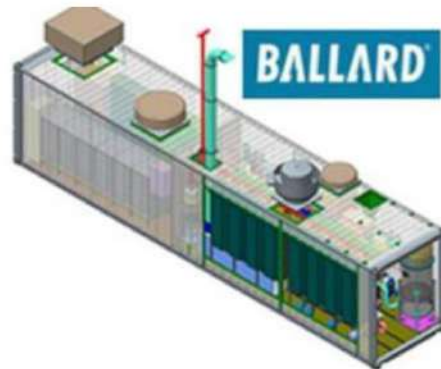

	PEMFC Technology	SOFC Technology
Fuel Demand	Pure Hydrogen, >95% CO-free (Catalytic Poisoning)	Syngas is acceptable, Reformate fuels are used.
Operational Demand	Rapid Startup	Baseload, On&Off is not preferable
Electric Efficiency	35~40%	50~60%
Total Efficiency	Max. 80%	Max. 90%
Residual Heat	60~70°C	200°C

SOFC Distributed Power System

Low

Emission

Low

Water required

24hrs

Operation

>80%

Efficiency

CCHP

Cold, Heat & Power

APPLICATIONS



Residential
CHP



Hospital
Hotel



Off-grid
Pipeline



Biomass Power
Generation



Server
Power



Commercial
Buildings

- + Compact & Distributed Power System for Buildings in Urban Areas
- + Usage of Existing Natural Gas Pipelines
- + High Energy Efficiency with Cold, Heat, Electricity Supply
- + Possible for Modulized Expansion and Load Adjustment on Demand



Industrial areas with
high power demand /
Science park/
Congregate housing/
Commercial buildings

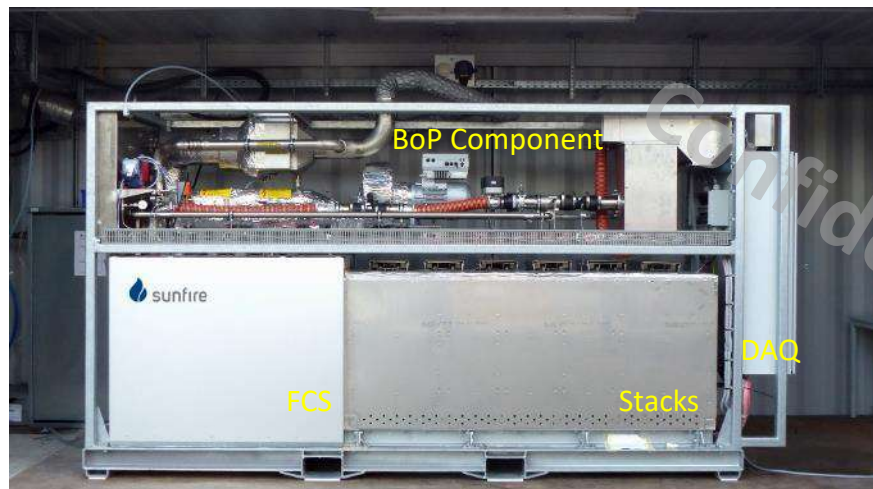

CSC GROUP

中鋁集團

PowerGen-50

Funded Project

Performance

C25

Fuel Type

Natural Gas

Net AC Power (kW)

25 kW

Heat (kW)

16 kW

Electricity Efficiency (%)

50%~55% (@70% Load)

Thermal Efficiency (%)

33%

Total Efficiency

83%

Operation

Electrical

380V@50/60Hz

3 phase, 4 wires

Noise Level

60 dBa @ 1m

Fuel consumption (M³/hr)

4.7

Pollutants

NO_x < 40 mg/kWh

CO < 50 mg/kWh

Fuel input pressure

15psig

Environment Temperature

0~40C ; 20% - 95% RH

MW-scale PEM Power Generator

Zero

Emission

Low

Water required

24hrs

Operation

80%

Efficiency

CHP

Heat & Power

APPLICATIONS



Highly Flexible
Expansion



Low Levelized Cost



Easy to Integrate



High Reliability

- + 200kW PEMFC Module, Flexibly expand to 1MW
- + Utilization of Residual Hydrogen from Industries
- + Low water consumption/Zero emission/ Rapid Startup
- + Connectable to grid and quick response to load demand
- + Complied with EU & CSA international standards for FC systems



200 KW FC

BALLARD

03

PART THREE

• Mobile Application Solutions •



Wide Range of Mobile Applications

PEM Fuel Cell System Control and Integration



Benefits of Fuel Cell Forklift



- + **Increase Efficiency、 Lower Cost**
Recharge 3 min for 8-hr use

- + **Eco-friendly、 Lower emission**
Zero emission with H₂ fuel, Higher total efficiency

- + **Space saving**
Eliminate Backup fleet of forklift

- + **Mobile POWER supply device**
Moving electricity supply, emergency backup power



Lead-acid
battery

Replacement
→
Compatibility



Fuel cell
system unit

Solution for Hydrogen Station

Specification

Daily Refueling 20 kg/day, 60 kg/day, 200 kg/day,
500 kg/day, 1,000 kg/day

Min. Inlet Pressure 2 MPa

Fuel Hydrogen

Refueling Pressure 35 MPa / 70 MPa

Refueling Capacity 0.3-0.7 kg/min

Operating Temp. -20~40 °C

Fuel Gun TK 16(25)

Design Pressure for Pipeline Low Pressure: 22 MPa,
High Pressure: 41 MPa / 90 MPa



Developing Strategy

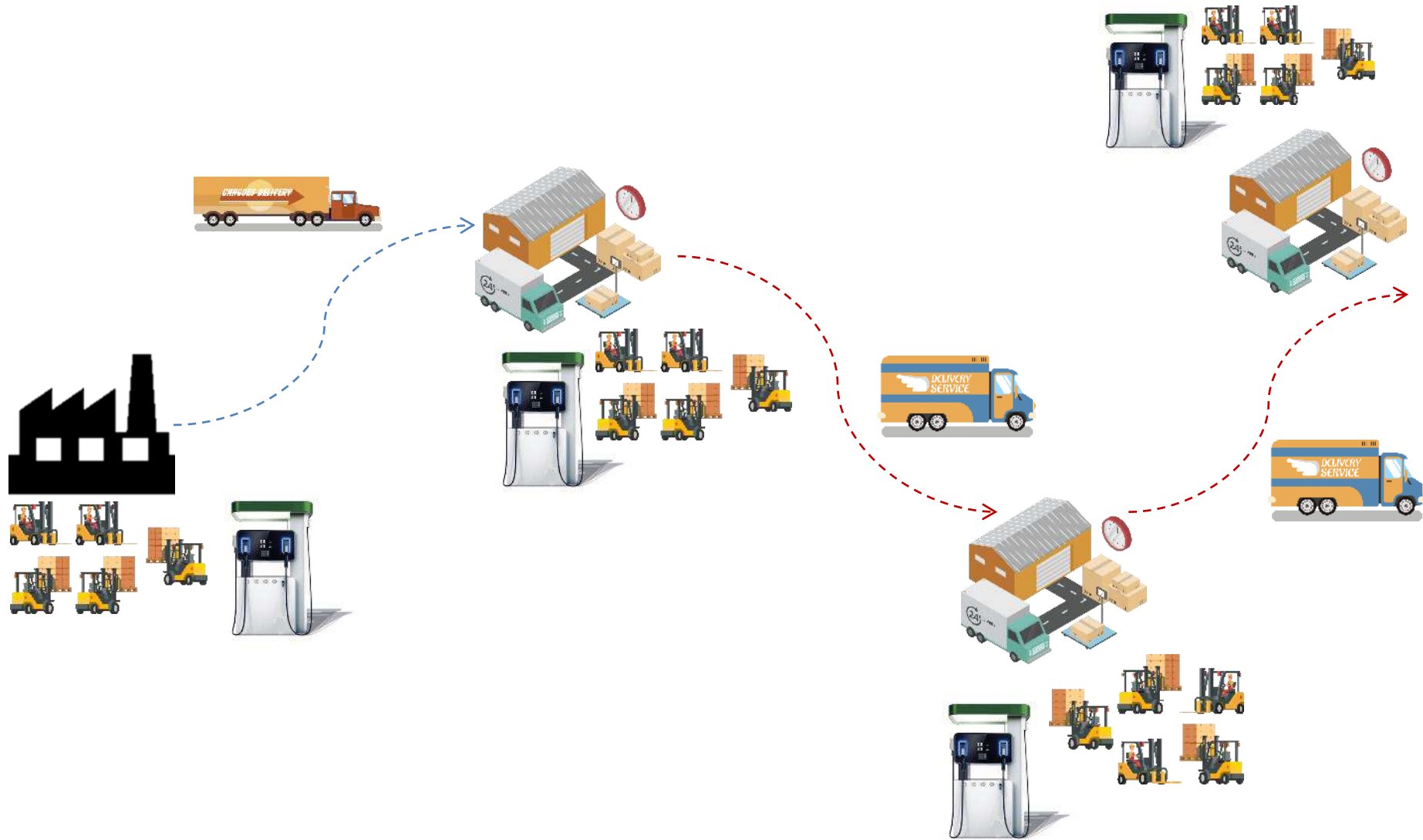

Strategic Partners





15.117.188.-136.205.96



Promise A Better Future!

ASIA HYDROGEN ENERGY CORPORATION
3F, No.60, Park Ave.II, Hsinchu Science Park,
Taiwan (R.O.C.)

www.ah2e.com

Becky.shih@ah2e.com





Introducing GlobalConnectB2B

The business-to-business global e-marketplace
for all industries

A digital solution born from the partnership between Singapore Business Federation
and Singapore small-medium enterprise Bizmann Systems (S) Pte Ltd.



GlobalConnectB2B

A business-to-business global e-marketplace for all industries brought to you by:



SBF is the **apex business chamber of Singapore** established in 2002 by the Singapore Government to represent and advance the interests of businesses in Singapore in trade, investment and industry.

Today, SBF represents a strong, diverse and vibrant core of over 27,000 Singapore and foreign businesses, key Singapore and foreign business chambers and industry associations.



Bizmann System (S) Pte Ltd is the **only operator in Singapore** with multiple, successful B2B e-commerce portals:

- F&B marketplace (2013): 2000 users; now covers cross-border
- Medical (2018): 8000 users. Launched with Singapore Medical Association
- Engineering Products / Services (2020): Launched recently
- Integration with OneConnect (China)



Disruptive technologies and business models are changing the world, businesses and lives.

COVID-19 global pandemic escalated the need for economies, businesses and livelihoods to adapt and transform.

In September 2020, Singapore Business Federation shifted to a higher gear with **GlobalConnect@SBF: Learn, Land and Localise** – a full suite of overseas business expansion services.

GlobalConnect@SBF works hand-in-hand with all kinds of businesses to **land and scale** them digitally and physically into markets abroad.

To help businesses find new customers, new markets and new partners without leaving home, **GlobalConnect@SBF** built

GlobalConnectB2B

a business-to-business global e-marketplace for all industries.



GlobalConnectB2B

A **business-to-business** (B2B)
e-marketplace...

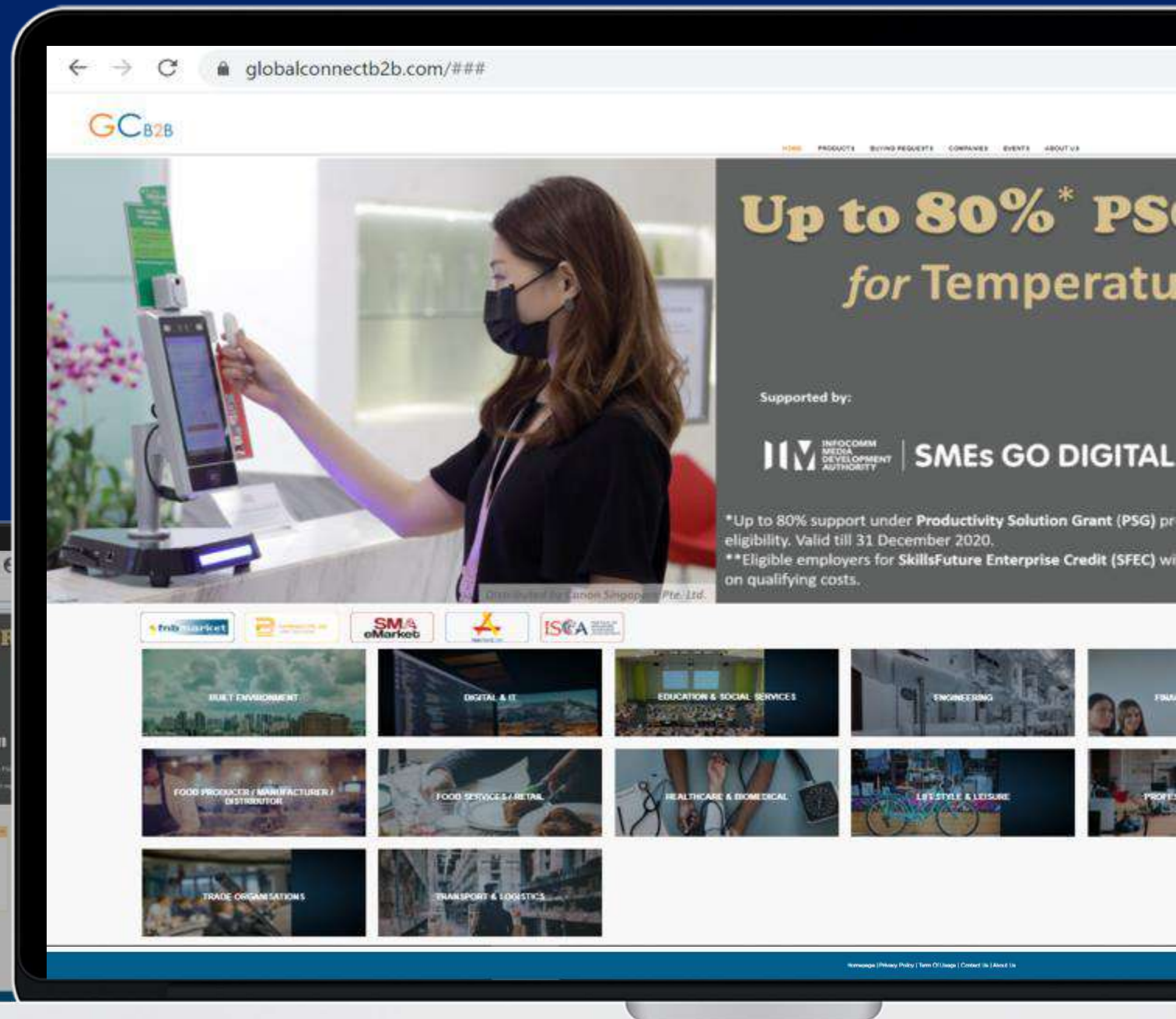

GlobalConnectB2B

...including **service industries**...

- social services
- financial services
- food services
- professional services

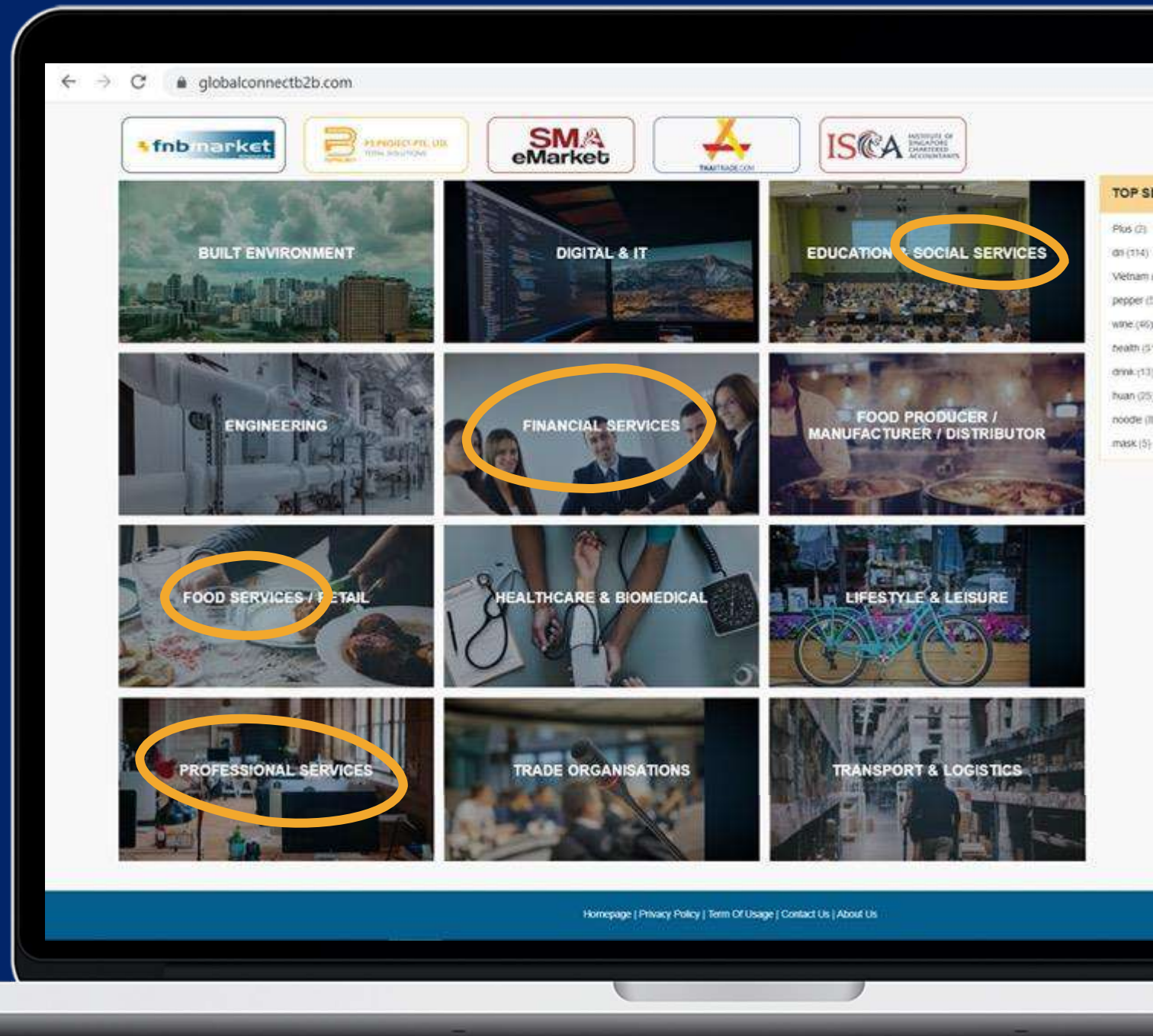

GlobalConnectB2B

...to connect businesses *globally*.

BROWSE BY AREA

Australia

Brunei

Cambodia

China

Germany

Hong Kong

Portugal

India

Indonesia

Japan

Kazakhstan

Macau

Singapore

Malaysia

Myanmar

Philippines

South Korea

Spain

Taiwan

Thailand

United Kingdom

United States of America

Vietnam

Rwanda



HOME PRODUCTS BUYING REQUESTS COMPANIES EVENTS ABOUT US

HOME / COMPANIES

BROWSE COMPANIES

IN THIS SECTION

TOP SEARCHES

BROWSE BY AREA

Australia
Brunei
Cambodia
China
Germany
Hong Kong
Portugal
India
Indonesia
Japan
Kazakhstan
Macau
Malaysia
Myanmar
Philippines
South Korea
Spain
Taiwan
Thailand
United Kingdom
United States of America
Vietnam
Rwanda

BUILT ENVIRONMENT

DIGITAL & IT

ENGINEERING

FINANCIAL SERVICES

FOOD SERVICES / RETAIL

HEALTHCARE & BIOMEDICAL

PROFESSIONAL SERVICES

TRADE ORGANISATIONS

GlobalConnectB2B

Since October 2020, **2,020 businesses onboarded***
and steadily growing

Why businesses join us:

Accelerates

- ✓ business scalability
- ✓ overseas growth

Streamlines

- ✓ corporate procurement

Trusted

- ✓ network of known buyers, suppliers and partners
- ✓ with secure cross-border B2B payment

Borderless

- ✓ reach into markets where businesses usually never go



* onboard with subscriber accounts



GlobalConnectB2B

A **business-to-business** (B2B) **global e-marketplace** for **all industries** built with 4 differences:

Service industries

- ✓ **Sell or source for services**, in addition to goods.

Proactive engagement

- ✓ No more listing and waiting to be found.
- ✓ **Proactively find and connect** with potential customers and partners in new markets.

Corporate procurement

- ✓ Can now be done **online** with **speed and traceability**.

Long-term partnerships

- ✓ **Grow and manage relationships online** whether or not engaging offline.



GlobalConnectB2B

Distinguished by 4 user benefits:

Connectivity

- ✓ Connects across **multiple industries**.
- ✓ Connects **service industries**.
- ✓ Connects **globally**.

Flexibility

- ✓ **Sell, source or do both** at the same time.
- ✓ **Proactively find and engage** new customers or partners in new markets.
- ✓ **Differentiate pricing** for different customer sets.

Reliability

- ✓ All subscribers are **genuine parties** onboarded by invitation only and known to their home governments.
- ✓ Traceability of transactions increase speed and costing accuracy in **corporate procurement**

Functionality

- ✓ Delivery fulfilment by **YCH**, a major player in Singapore's **world-class global logistics**.
- ✓ **Fast and affordable cross-border standard and digital trade financing** by Singapore's world-class global financial capabilities.





- **Supports** all sectors
- **Enables** exports of services as well as goods
- **Creates** new markets, new customers and new partnerships
- **Provides** seamless, time-saving, cost-efficient *and secure* supply chains from logistics, compliance to traceability
- **Offers** near-instantaneous, cross-border money transfers at wholesale FX rates (**coming soon!**)

GlobalConnectB2B **connectivity** for growth.

Connects across businesses, industries and markets.

- Built Environment
- Digital & IT
- Education & Social Services
- Engineering
- Financial Services
- Food Producers, Manufacturers & Distributors
- Food Services & Retail
- Healthcare & Biomedical
- Lifestyle & Leisure
- Professional Services
- Trade Organisations
- Transport & Logistics



Embassies
Trade offices
Business chambers



ASEAN



Brunei



Cambodia



Indonesia



Malaysia



Myanmar



Philippines



Thailand



Vietnam



AFRICA



Mauritius



Rwanda

AMERICAS



Chile



Mexico



USA

NORTH ASIA



China



Hong Kong



Japan



Macau



Taiwan



South Korea

SOUTH ASIA



India



Maldives

EUROPE & UK



Germany



Portugal



Spain



UK

OCEANIA



Australia



- **No more waiting.** No more being restricted to listing and then waiting and hoping to be found and contacted.
- **Take charge instantly.** Start searching at once for new customers, partners and markets.
- **Cross industry barriers.** Begin exploring other industries which otherwise seem unreachable.

GlobalConnectB2B **flexibility** *for the proactive.*

Take initiative as soon as an account is created. Immediately begin:

- profiling and promoting offerings,
- initiate active searches for new customers, or
- cross into other industries for new ideas and adjacent opportunities.

ATARASHI CULTURE PTE LTD

HOME COMPANY PROFILE COMPANY NEWS BUYING REQUEST RECRUITMENT GALLERY **INVESTMENT/PARTNERSHIP/FRANCHISE**

INVESTMENT/PARTNERSHIP/FRANCHISE

Franchise

Franchise Description

Unagi VS Salmon is a business format franchise that offers its distinctive F&B concept incorporating exclusive rights for a party to operate at a specific location or territory for a period of time.

The Franchise Package

- Rights to operate the Unagi VS Salmon concept
- Use of Unagi VS Salmon's distinctive identity and trademark
- Initial training and start-up support
- On-going support and training e.g. Business reviews, marketing, market research
- Transfer of new ideas e.g. improvements to business systems, product development, R&D
- Loan of Unagi VS Salmon Operations Manuals
- Marketing and PR support
- Supply of products

ATARASHI CULTURE PTE LTD

HOME **COMPANY PROFILE** COMPANY NEWS BUYING REQUEST RECRUITMENT GALLERY INVESTMENT/PARTNERSHIP/FRANCHISE

COMPANY PROFILE

Company:	Atarashi Culture Pte Ltd		
Company UEN:	201829650D (Service Provider)		
Company Type:	Private Company (Service Provider)	Company Size:	
Area:	Singapore	Year Registered:	2018
Main Business:	Casual Japanese Restaurant: Unagi VS Salmon		
Main Categories:	Food Services / F&B / Restaurants/Cafes		

CERTIFICATIONS

Certificate	Name	Authority	Authorized Date	Valid Till
-------------	------	-----------	-----------------	------------



- **No more one-size-fits-all.** Solutions and offers can now be customised separately and privately for different customer sets.

GlobalConnectB2B **flexibility** *for differentiation.*

Customise offers separately and privately. Purchase orders can be created privately and separately to deliver different packages and solutions for different customers.

← → ↻ globalconnectb2b.com/member/my.php?mid=23 🔍 ☆ 📧 ⚙️ 👤 ⋮

MEMBER CENTER

Home

Data Manager ▾

Products

Events

Recruitment

Transaction

Report

Masterdata

Gallery

MEMBER CENTER / TRANSACTION

MARKET LIST STEP 1: QUOTATION STEP 2: PURCHASE ORDER STEP 3: DELIVERY ORDER STEP 4: INVOICE

Show 10 ▾ entries Search:

Transaction No.	Reference No	To	Created Date	Download PDF	Action
No data available in table					

Showing 0 to 0 of 0 entries Previous Next

sbfsupplier



- **Worry-free usage.** Transact safely, securely and privately with peace of mind.

GlobalConnectB2B **reliability** *for security.*

Delivers the **technological security** expected of a world-class e-commerce portal:

SSL encryption

- ✓ Send and receive data securely.

HTTPS

- ✓ Surf the portal safely.

User authentication

- ✓ Log in and manage account in complete privacy.

Firewalls

- ✓ Safeguards data and information in the cloud and data centres.





- **Engage with confidence.** With assurance that the other party is a real business.

GlobalConnectB2B **reliability** in *know-your-counterpart.*

Delivers **genuine players** who could become long-term partners:

First-level identity check

✓ by respective embassies, trade offices and business chambers.

By-invitation only

✓ to businesses who are engaged by portal operators before onboarding.

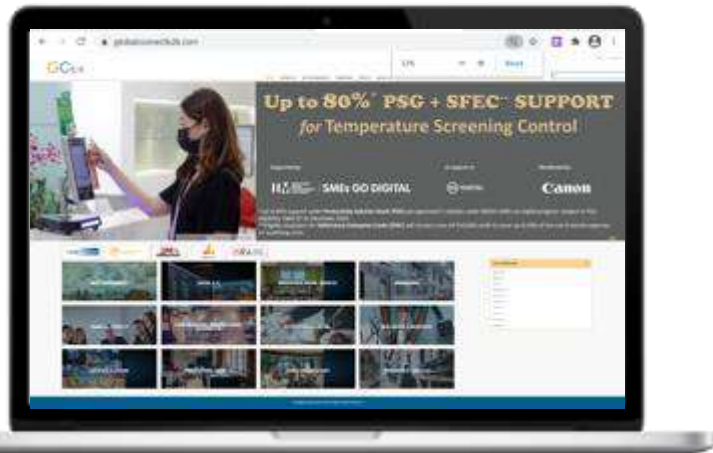

From Singapore, connects with

- embassies
- trade offices, and
- business chambers

...to connect with businesses in **ASEAN**



KADIN



MATRADE



PCCI



ThaiTrade



VTO/VCCI



YEAC

...or with businesses beyond ASEAN



AFRICA



Rwanda

AMERICAS



Argentina



Brazil



Mexico



American Chamber

ASIA



JETRO

EUROPE



EuroCham



Germany



Poland



Portugal

OCEANIA



AusTrade

GlobalConnectB2B

All features delivered in one single-flow, seamless and complete user experience (UX) from selling/sourcing, payment to delivery fulfilment:

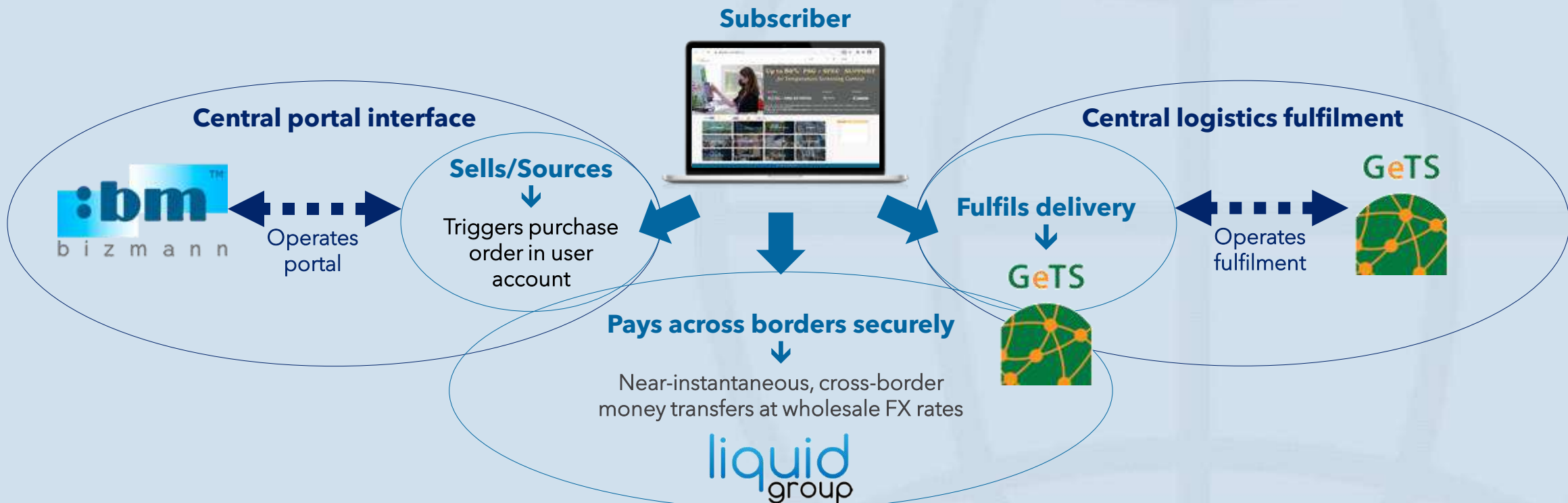

GlobalConnectB2B

Free subscription for all
non-Singapore businesses
until 31 December 2021

Join us!

- Scan QR code
- Fill in your business information
- And you will hear from us within 3 working days!



Or ask us!

Email to globalconnect@sbf.org.sg

Or call our hotline +65 6701 1133

Or find us at Level 6 SBF Centre, 160 Robinson Road, Singapore 068914

Or google us at <https://globalconnect.sbf.org.sg>





See you online soon.

March 2021 International Edition Update 3.2.3 © Singapore Business Federation and BizMann Systems (S) Pte. Ltd. These materials and all related intellectual properties and communications herein are strictly confidential and intended solely for the party to whom they are addressed or presented to. If you are not the intended recipient, do not distribute or copy any part of these materials or disclose the same to any party. These materials and all graphics, words and contents herein and all intellectual property arising hereto belong solely to the joint ownership of Singapore Business Federation and BizMann Systems (S) Pte. Ltd. and no part hereof shall be reproduced or disseminated in any way without the prior written joint permissions of Singapore Business Federation and BizMann Systems (S) Pte. Ltd.





AI Tool Makes Creating Professional Product Photos Easy

ShowHue / CEO / Hannie

hannie@showhue.com

2021/6/10

Founder & CEO @ ShowHue

Hello! I'm Hannie Liu

- 💻 SaaS & Software heavy user
- 👤 Entrepreneur with programming skill
- 👤 Former CMO @EdTech startup
- 👉 AppWorks Accelerator #22 / NTUTEC #1
- 📍 Taipei, Taiwan
- 🌐 [hannieliu](#)
- 📷 [hannieliu](#)



Why Good Product Photos Matter ?

01



Mary Meeker

Digital Transformation Is Accelerating

Covid-19 has upended our modern lives in ways
we're just starting to understand.
Mary Meeker's COVID-19 Internet Trends Report

Revenue in the eCommerce market is projected to reach US\$2,723,991m in 2021

ShowHue: AI Tool Makes Creating Professional Product Photos Easy

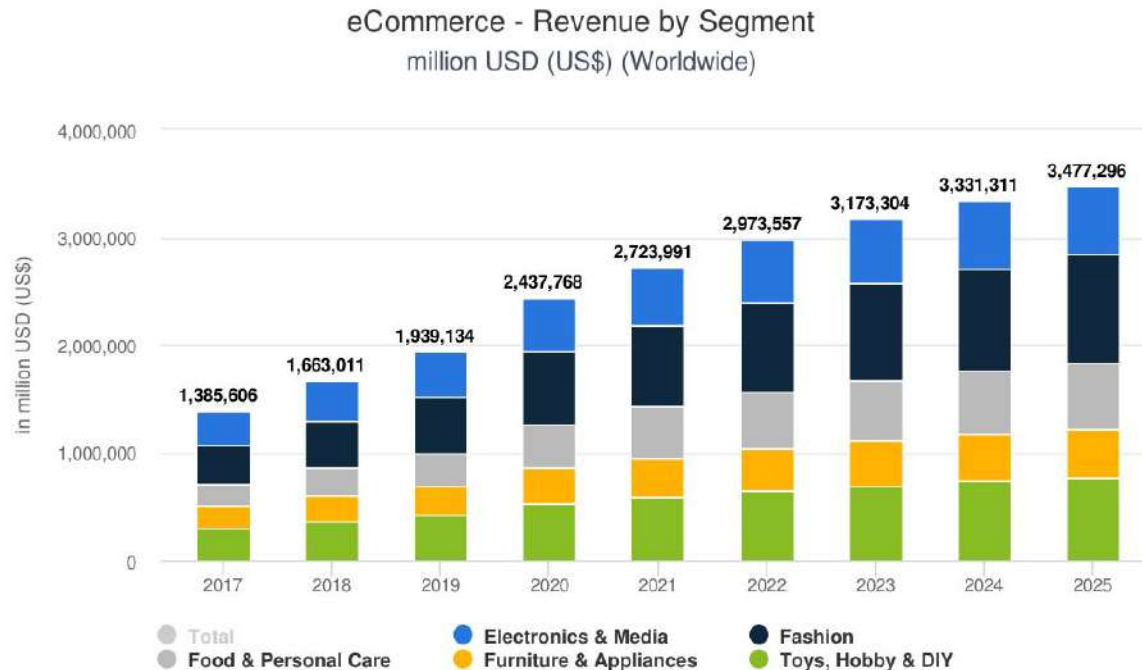

Market share of leading e-commerce software platforms and technologies worldwide as of April 2020*

ShowHue: AI Tool Makes Creating Professional Product Photos Easy

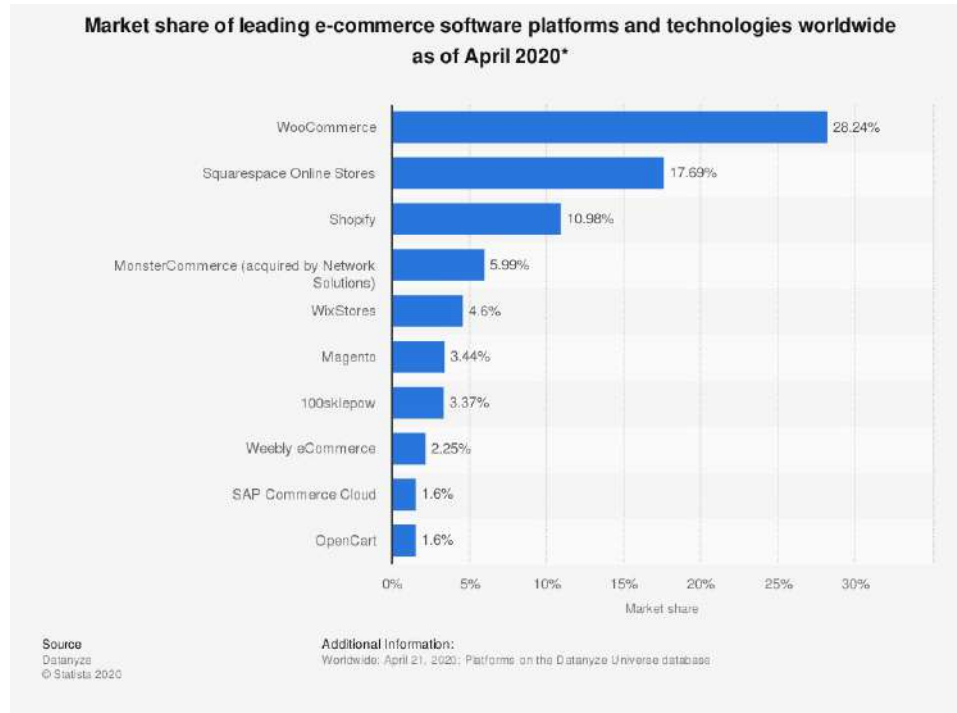

Why Good Product Photos Matter?

ShowHue: AI Tool Makes Creating Professional Product Photos Easy



67%

of consumers

say that the quality of a product image is “**very important**” in selecting and purchasing the product.

E-Commerce Process

ShowHue: AI Tool Makes Creating Professional Product Photos Easy



Photo & Edit

The first and **most important** step of eCommerce sellers.

Upload images and information to online store **again and again**.



Marketing



Customer Service

How to Create
Good Photos
With
Smart Tool
?

02

A.I. Makes your products look gorgeous

ShowHue: AI Tool Makes Creating
Professional Product Photos Easy



How It Works

ShowHue: AI Tool Makes Creating Professional Product Photos Easy



01 Upload

Upload your product snapshot

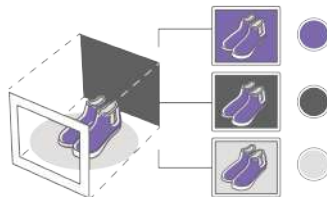

02 Detect

Detect your product with AI

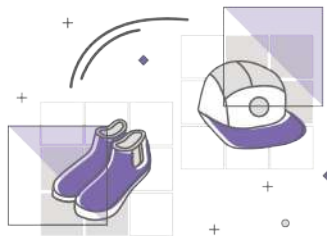

03 Create

Create the photo in a few clicks

Awsome Features

ShowHue: AI Tool Makes Creating
Professional Product Photos Easy

Create photos with A.I.

Create is a tool that helps you generate realistic-looking product photographs with A.I. Grabbing the shopper's attention

Create

Automate selling process

Upload is a tool that lets you facilitate your selling process with auto-tagging. Boost your store's SEO.

Upload

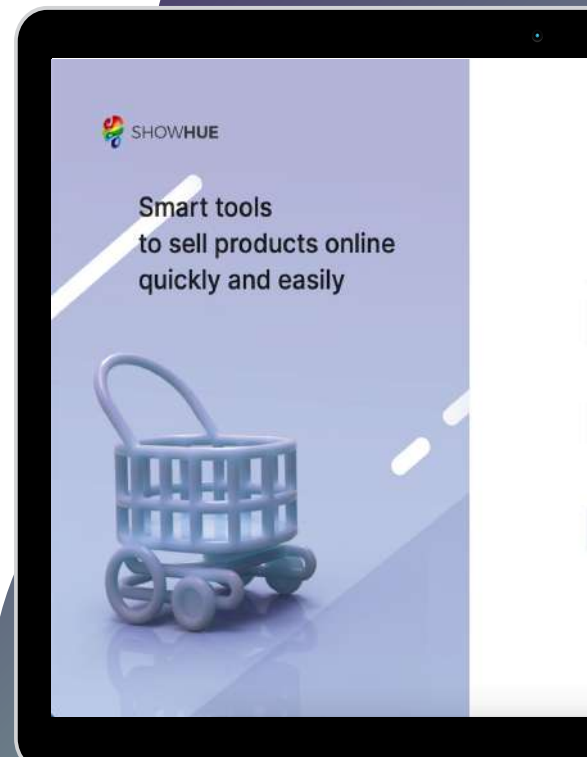

Why we are Different

ShowHue: AI Tool Makes Creating Professional Product Photos Easy

No code



Easy to use



Etsy style



Focus eCommerce



**Get Your
Products
Online
Fast
!**

03

Integration

ShowHue: AI Tool Makes Creating Professional Product Photos Easy



Shopee

Shopee is the leading eCommerce marketplace in Southeast Asia.



WooCommerce

WooCommerce is an open-source eCommerce plugin for WordPress..



Shopify

Shopify is a simple way to create an online store to list products..

Use cases

ShowHue: AI Tool Makes Creating Professional Product Photos Easy

160+ SMBs

We make selling process easier for everyone. Seller, influencer or designer, you can find several scenarios suitable for your business.



5+ Enterprise

Bring your business to a new perspective. We offer a clear and standard API, you can easily access our featured tools the way you want.

We are looking for Global Partners!

ShowHue: AI Tool Makes Creating Professional Product Photos Easy

- U.S.
- Asia
 - Japan
 - Singapore

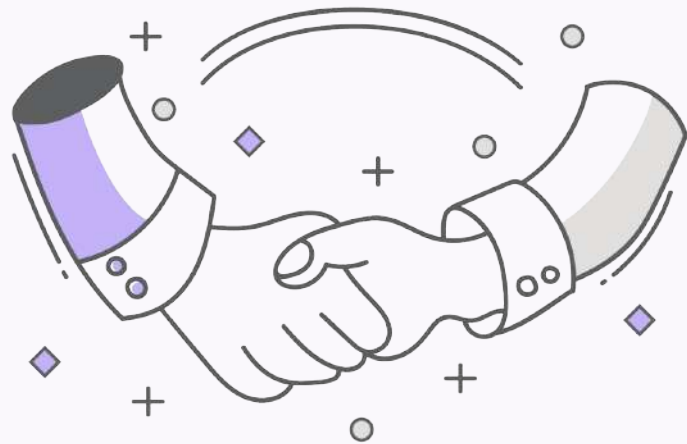

ShowHue: AI Tool Makes Creating Professional Product Photos Easy

Key Takeaways



With more and more people shopping online each year, there's never been a better time to start an online store.



Your product pages should have high-quality product image. This will instill trust and help shoppers with their research.



Plus, with tools like ShowHue, it couldn't be more simple to set up your business.



ShowHue

Chat with Us

ShowHue.com
info@showhue.com
+886-973-020-537